



6/5 Summerlea Grove Hawthorn VIC

1 1

Immaculate ground floor studio apartment offers astute buyers and investors exceptional entry to this coveted blue ribbon locale. Privately tucked at the rear with inviting gardens on entry, this neat and impeccably maintained studio apartment provides an exceptionally low maintenance lifestyle while featuring a stylishly appointed kitchen with electric cooktop and oven, generous storage and dishwasher for your cooking convenience, electric panel heating and a pristine bathroom boasting an oversized shower and modern vanity. Desirably positioned in a location that delivers immediate access to transport, cosmopolitan Glenferrie Road shopping and cafes, Yarra River parklands and bike trails and positioned a short tram trip to Bridge Road shopping, restaurants and bars, Camberwell Junction and Rivoli Cinemas together with easy access to the CBD and Swinburne University of Technology, it offers an exciting opportunity to reap the

Price : \$ 240,000

View : <https://www.alexkarbon.com.au/sale/vic/east/hawthorn/residential/apartment/6208742>



James Rapita
9326 8883



Alex Puglia
03 9326 8883

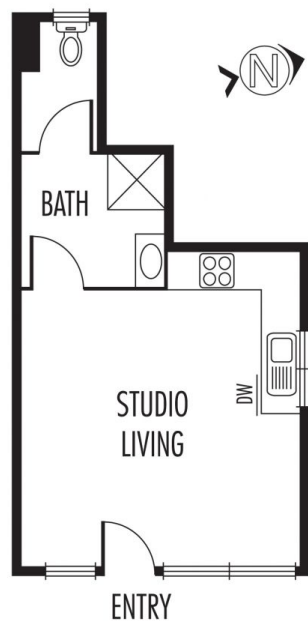

Disclaimer: Please note plans are indicative only and not drawn to exact scale. All dimensions are approximate. Potential buyers should satisfy themselves of any pertinent matters.