



17/315 Flemington Road North Melbourne VIC

1  1  1 

Ideally situated opposite the expansive greenery of Royal Park with Flemington Road's iconic plantation streetscape, city bound tram service and dedicated bicycle lane at your door, this single bedroom apartment certainly boasts impressive inner city lifestyle advantages. A remote-controlled driveway gate and intercom assure peace of mind upon entering and safely secure the car. Once inside, the apartment is filled with natural light thanks to a sunny north westerly aspect. The central lounge separates the bedroom from the dining zone and extends to an intimate covered balcony. The tidy kitchen features stainless steel appliances and space for daily meals. The double bedroom is generously scaled and incorporates floor to ceiling, mirrored built-in wardrobes. Close by are handy communal laundry facilities also. Take full advantage of the secure off-street parking included to explore the city by tram which will have you at Melbourne's

Price : \$ 330,000

View : <https://www.alexkarbon.com.au/sale/vic/inner-city/north-melbourne/residential/apartment/6208967>



Charles Bongiovanni
03 9326 8883

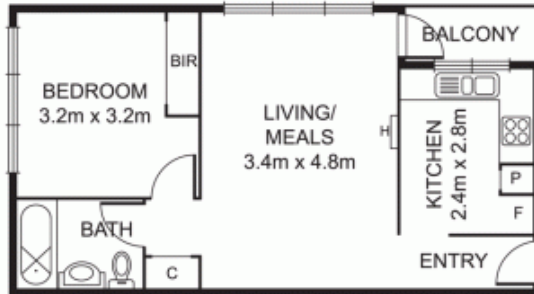

Disclaimer: Please note plans are indicative only and not drawn to exact scale. All dimensions are approximate. Potential buyers should satisfy themselves of any pertinent matters.