



20/70 Racecourse Road North Melbourne VIC

Large open plan double office with just over 110 sqm of space.
Office includes private kitchen facilities with dishwasher.
Two (2) Car basement parking with additional basement parking options available upon request (at additional cost).

Two Elevators service the complex with a window enclosed stairwell.
Common area kitchenette and toilet facilities.

Surrounded by Public Transport with Both the 57 & 59 Tram (stops 22) on either side of the building and Flemington Bridge Train Station just behind the complex. All within walking distance.

Errol Street, Boutique Shops, Cafes & Restaurants less than 5 mins away & Newmarket Shopping precinct only 2

Building Size : 118 sqm
View : <https://www.alexkarbon.com.au/lease/vic/inner-city/north-melbourne/commercial/offices/6209206>



Gianni Fazzari
03 9326 8883

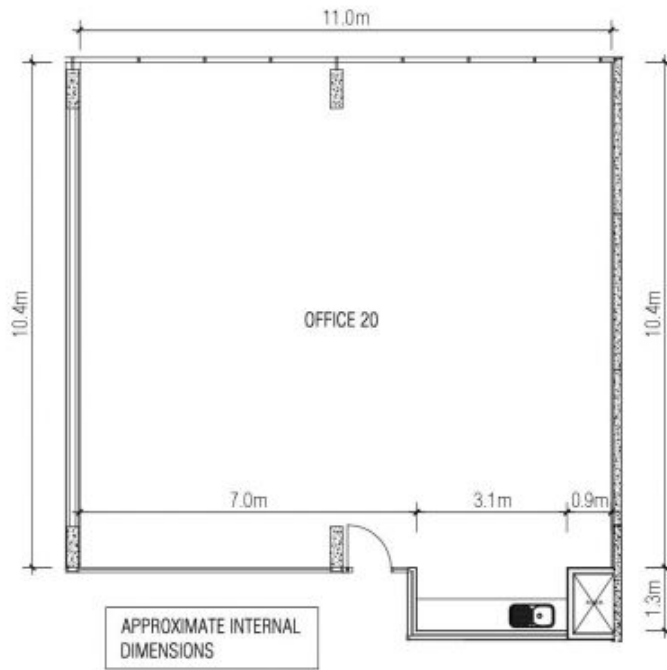

THIS DIMENSIONED PLAN IS NOT TO BE USED FOR CONTRACT PURPOSES.

The measurement shown on this plan are not to be construed as an accurate representation in any contract document. The dimensions may vary due to the service and structural design during the construction process.

70 Racecourse Road

NORTH MELBOURNE

OFFICE 20

OFFICE INTERNAL AREA: 118m²

13-05-2016



DISCLAIMER: THIS PLAN IS INDICATIVE ONLY. DIMENSIONS AND AREAS ARE APPROXIMATE AND ARE SUBJECT TO CHANGE WITHOUT NOTICE. THE LOCATION OF WALLS, FIXTURES AND FITTINGS ARE PROVIDED FOR GENERAL INFORMATION PURPOSES ONLY AND MAY NOT BE REPRESENTATIVE OF THE FINAL PRODUCT. IT IS AN ARTIST'S IMPRESSION AND IS SUBJECT TO CHANGE AS REQUIRED BY THE VENDOR. INTERNAL MEASUREMENTS ARE TAKEN FROM THE CENTRE LINE OF PARTY WALLS AND THE EXTERNAL FACE OF CORRIDORS & THE OUTSIDE WALL UNLESS CLEARLY NOTED OTHERWISE. LOOSE FURNITURE, WHITE GOODS AND PLANTERS ARE NOT INCLUDED UNLESS STATED OTHERWISE.