



**409/187 Boundary Road North Melbourne VIC**

1  1  1 

Located in the distinctive Serra Apartments complex, this fourth level residence offers spacious living in a prime city-edge location. Currently leased until March 2020. Rental \$303 pw.

- Open-plan living/dining area
- Stone-top kitchen and stainless steel appliances.
- Approx 8 m2 terrace
- Lower-level car space
- Split-system heating/cooling and double glazed windows
- European laundry
- Video intercom/secure entry foyer
- Lift access
- Walk to Flemington Bridge Station and Racecourse Road trams, Royal Park
- Close to hospital/university precincts and Citylink

**Price** : \$ 329,000

**View** : <https://www.alexkarbon.com.au/sale/vic/inner-city/north-melbourne/residential/apartment/6209381>



**Charles Bongiovanni**  
03 9326 8883

Alexkarbon Real Estate Pty Ltd

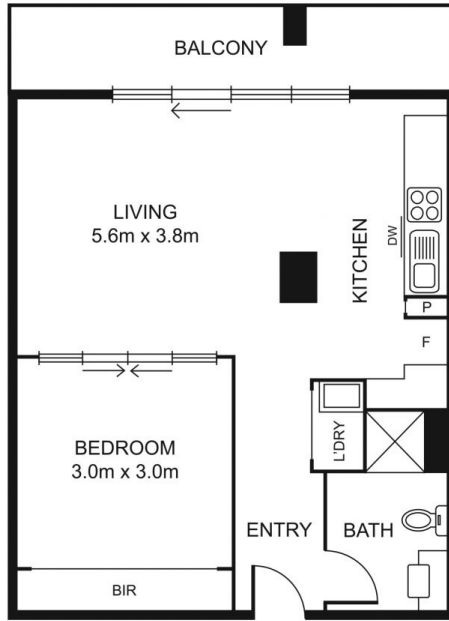

Disclaimer: Please note plans are indicative only and not drawn to exact scale. All dimensions are approximate. Potential buyers should satisfy themselves of any pertinent matters.