

9/201 Abbotsford Street North Melbourne VIC

2 2 1

The concepts and creativity that defines the most successful contemporary conversions are given an address: TRAMHOUSE, an iconic context for inner-city life. As one of North Melbourne's most highly desired settings this boutique residence is appointed to honour not only the principles of cutting-edge design but the story of rich history and heritage. Impressive original brickwork, retained and re-integrated, today inform soaring cathedral ceilings where sky windows shower the lounge in natural light throughout the day and Bosch/stone kitchen keeps the contemporary in frame. Superb ensuite bedrooms, both upstairs and down, each individually interpret the past in the present, further complemented by a secure garage, air-conditioned living, Euro laundry and, of course, surrounds that relish the café culture of Errol Street as well as trams, trains - in fact every inner-city attraction.

View : <https://www.alexkarbon.com.au/sale/vic/inner-city/north-melbourne/residential/townhouse/6209527>



Alex Puglia
03 9326 8883



Gianni Fazzari
03 9326 8883

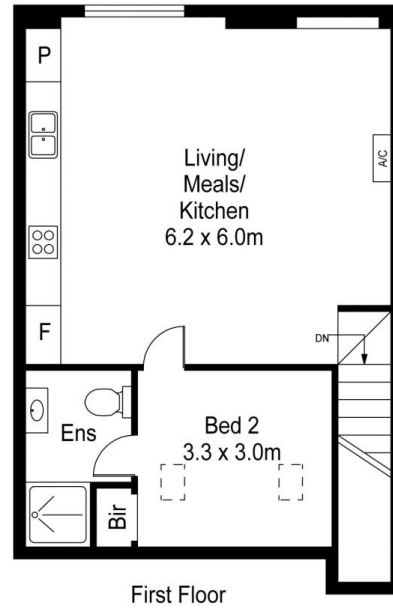
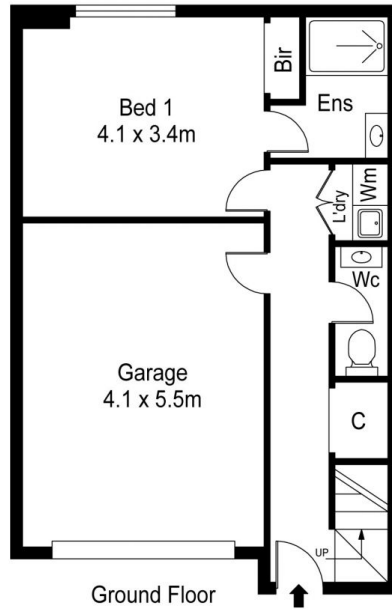

Scale in metres. Indicative only. Dimensions are approximate. All information contained herein is gathered from sources we believe to be reliable. However we cannot guarantee its accuracy and interested persons should rely on their own enquiries



9/201 Abbotsford Street, North Melbourne