



228 Maribyrnong Road Moonee Ponds VIC

4 1 4

An elite Moonee Ponds address of convenience for this serene Victorian sanctuary featuring superb era-charm, front and rear access and vast north facing tranquil gardens. The busy road is forgotten at the front door with a laced veranda entry to the captivating calm of 'Montrose' that boasts an exquisite intact hallway arch, ceilings of hallowed heights and stunning fireplaces in all four bedrooms. As new floors of honeyed tones lead through a beautiful door of original blue and red stained glass to the heart of this home that enjoys a picturesque outlook to the expansive backyard. The perfect venue for a party with French doors extending the entertaining domains from the living room to a spacious alfresco veranda and open gardens with a spacious double remote garage accessed from a bluestone cobbled lane. The rear floorplan incorporates a separate modern kitchen with a chef's Westinghouse stainless oven and microwave, walk in

View : <https://www.alexkarbon.com.au/lease/vic/north/moonee-ponds/residential/house/6209558>



Sarah Hutchings
9326 8883



Alec Sabatino
9326 8883

228 MARIBYRNONG ROAD, MOONEE PONDS

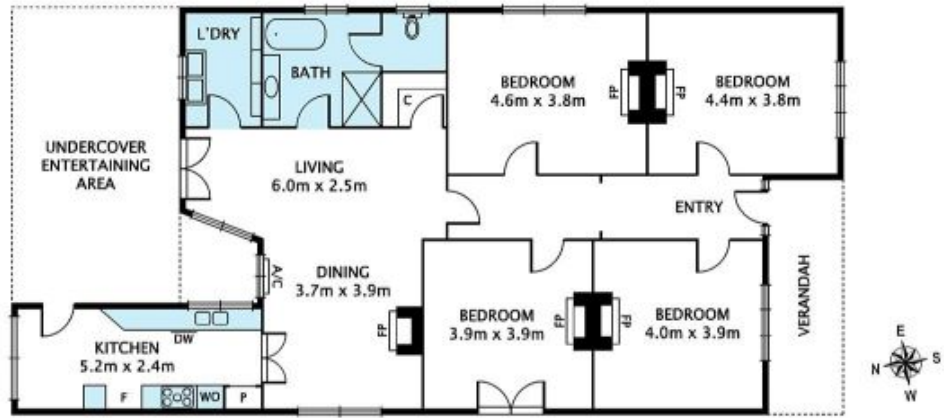

Disclaimer: Please note plans are indicative only and not drawn to exact scale. All dimensions are approximate. Potential buyers should satisfy themselves of pertinent matters.