



**153 Flemington Road North Melbourne VIC**

4 🏠 2 🚗 2 🚗

Quintessentially Victorian and contemporary in flavour, "Dulcie" a statuesque four bedroom, two bathroom plus powder room double-storey Victorian terrace affords a luxurious, contemporary lifestyle with spectacular views of Royal Park and the Nature Play Playground. Showcasing architect designed renovations, this executive entertainer offers a brilliantly functional layout that features towering ceilings/rosettes, beautifully restored staircase and traditional open fireplaces throughout, open style living, dining zones and custom-designed kitchen starring stone benches, imported Italian 6-burner/twin oven Steel range cooker, quality integrated refrigerator/freezer and dishwasher. All complemented by private alfresco zone with natural gas barbeque and wood-fired pizza oven. Additionally, the property presents opulent ensuite master/study, fourth bedroom/home office, private balcony, BIRS/storage, deluxe bathroom, plantation shutters,

**Price** : \$ 2,390,000

**View** : <https://www.alexkarbon.com.au/sale/vic/inner-city/north-melbourne/residential/house/6991597>



**Alex Puglia**  
9326 8883



**Jacqueline Iversen**  
03 9326 8883

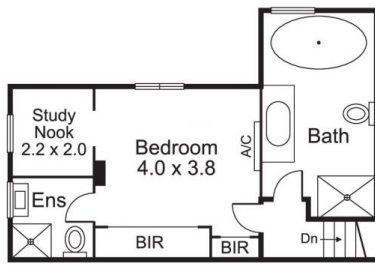

SPLIT LEVEL

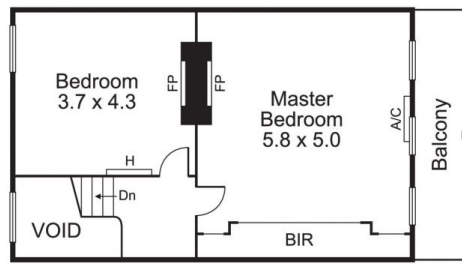

FIRST FLOOR

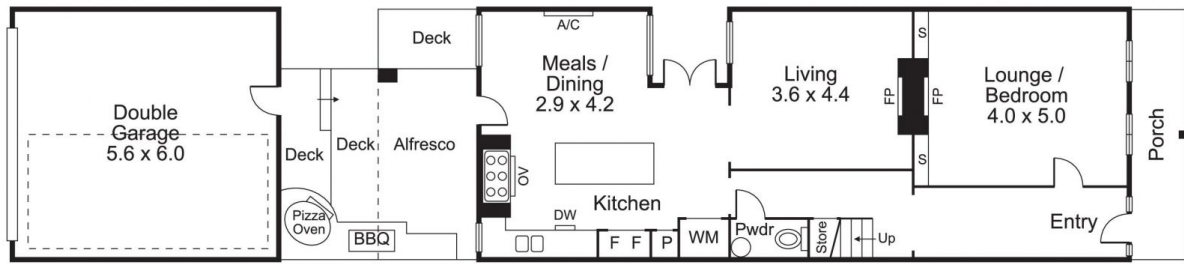

GROUND FLOOR



Every care has been taken to verify the accuracy of the net internal area. Prospective purchasers are advised to make their own enquiries to satisfy themselves in all respects.